



PARCEL #: 545130-0005

OWNER INFORMATION:

SHARMA ABHISHEK and SHWETA  
7905 W MERCER WAY, MERCER ISLAND, WA 98040

LEGAL DESCRIPTION:

MERCER ISLAND PARK ADD LOT B MERCER ISLAND SHORT PLAT NO 82-08-16 REC NO 8308173001 SD SHORT PLAT DAF - LOT 1 & POR OF LOT 2 LY S OF LN AKA LN A & POR OF LOT 13 W OF W MERCER WAY & S OF SD LN A BEG AT MOST SLY COR OF SD LOT 13 TH S 89-22-20 W 318.42 FT TH N 37-21-40 W 89.33 FT TH N 33-55-40 W 85.50 FT TO A NXN & TPOB OF SD LN A TH N 89-22-20 E ALG SD LN A TO NXN WITH WLY R/W LN OF SD W MERCER WAY  
Plat Block:  
Plat Lot: 1-2 & 13

ZONING AND SITE DATA

ZONE: R-15

SETBACKS:  
FRONT: 20'  
SIDES: 15' (sum)  
BACK: 25'

SITE / LOT SF BASED ON SURVEY 19,791 SQFT, (.45 ACRES)

ADDRESS: 7905 W MERCER WAY, MERCER ISLAND, WA 98040



National Design Project LLC  
1010 SE Everett Mall Way  
Suite 102  
Everett, WA 98204

(425) 622-7085

info@nationaldesigncorp.com  
www.nationaldesignwa.com

© National Design Corporation

This drawing along with referenced drawings and specifications are and shall remain the property of National Design. These are specifically developed for the project shown on this drawing and shall not be used for extensions of this project or any others projects without a written agreement with or approval.

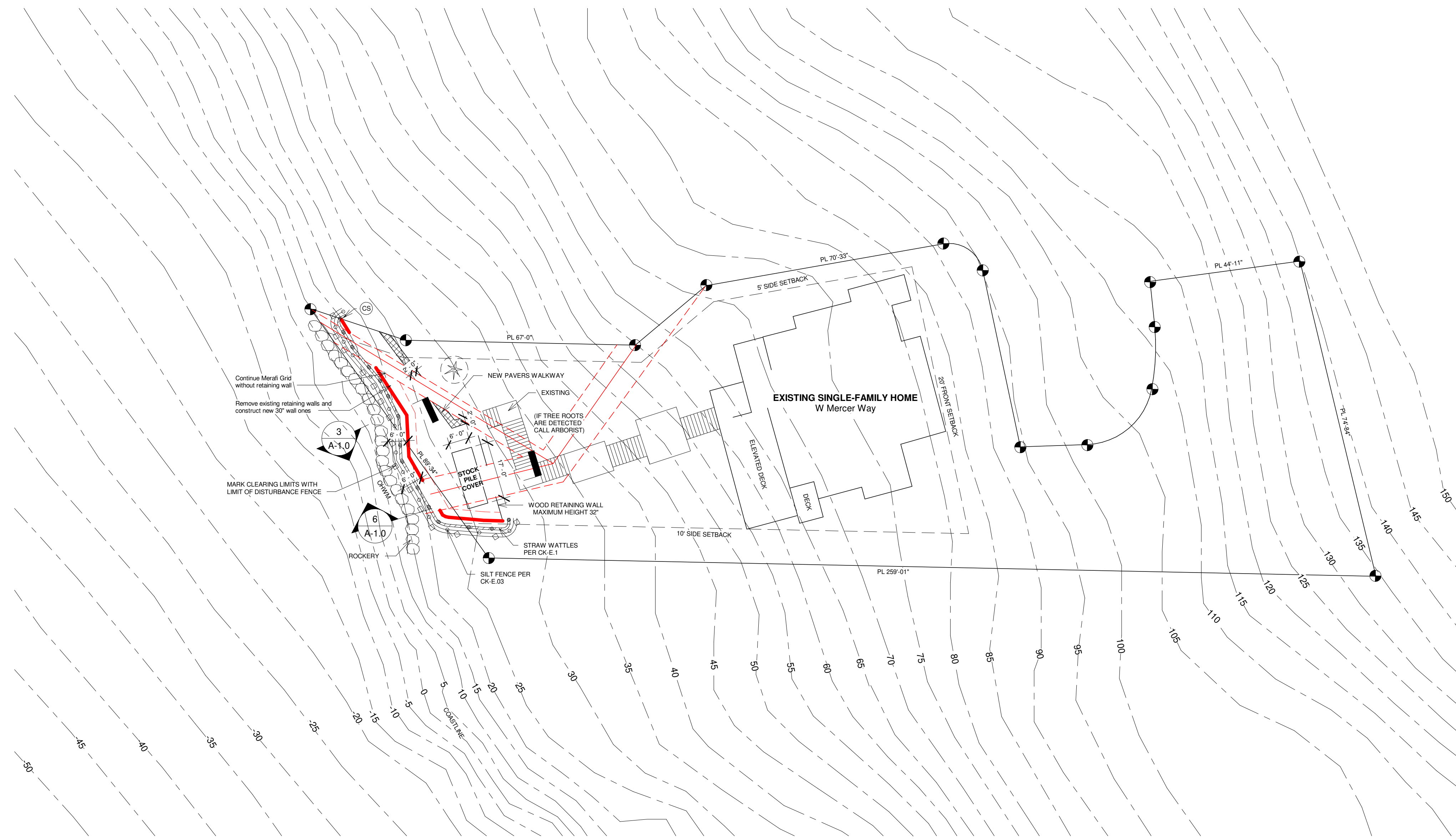

1 CSWPPP and TESC PLAN  
1" = 20'-0"

TEMPORARY EROSION and SEDIMENT CONTROL

**TESC AND SMALL PROJECT STORMWATER POLLUTION PREVENTION PLAN (SWPPP) BEST MANAGEMENT PRACTICES**

TO PRESERVE NATIVE VEGETATION AND TO CLEARLY SHOW THE LIMITS OF DISTURBANCE, THE PERIMETER OF THE AREA TO BE CLEARED SHALL BE MARKED PRIOR TO CLEARING OPERATION WITH VISIBLE FLAGGING, ORANGE PLASTIC BARRIER FENCING AND/OR ORANGE SILT FENCING AS SHOWN ON THE SWPPP. VEHICLES WILL ONLY BE ALLOWED IN THE AREAS TO BE GRADED, SO NO COMPACTION OF THE UNDEVELOPED AREAS WILL OCCUR.

NO SOILS SHALL REMAIN EXPOSED AND UNWORKED FOR MORE THAN 2 DAYS FROM OCTOBER 1 TO APRIL 30. ONCE THE DISTURBED LANDSCAPE AREAS ARE GRADED, THE GRASS AREAS WILL BE SEED OR SODDED. ALL STOCKPILES WILL BE COVERED WITH PLASTIC OR BURLAP IF LEFT UNWORKED.

A STRAW WATTLE SHALL BE PLACED AT THE END OF SWALES TO PREVENT EROSION AT THE OUTLET OF THE SWALE.

BEST MANAGEMENT PRACTICES (BMP) SHALL BE INSPECTED AND MAINTAINED DURING CONSTRUCTION AND REMOVED WITHIN 30 DAYS AFTER THE COUNTY INSPECTOR OR ENGINEER DETERMINES THAT THE SITE IS STABILIZED, PROVIDED THAT THEY MAY BE REMOVED WHEN THEY ARE NO LONGER NEEDED.

THE SWPPP WILL BE IMPLEMENTED AT ALL TIMES. THE APPLICABLE EROSION CONTROL BMP'S WILL BE IMPLEMENTED IN THE FOLLOWING SEQUENCE:

- MARK CLEARING LIMITS.
- INSTALL STABILIZED CONSTRUCTION ENTRANCE.
- INSTALL PROTECTION FOR EXISTING DRAINAGE SYSTEMS AND PERMANENT DRAIN INLETS.
- ESTABLISH STAGING AREAS FOR STORAGE AND HANDLING POLLUTED MATERIAL AND BMP'S.
- INSTALL SEDIMENT CONTROL BMP'S.
- GRADE AND INSTALL STABILIZATION MEASURES FOR DISTURBED AREAS.
- MAINTAIN BMP'S UNTIL SITE STABILIZATION, AT WHICH TIME THEY MAY BE REMOVED.

ON-SITE STORMWATER MANAGEMENT BMP'S USED FOR RUNOFF FROM ROOFS AND OTHER HARD SURFACES INCLUDE: FULL DISPERSION, ROOF DOWNSPOUT FULL INFILTRATION OR DISPERSION SYSTEMS, PERFORATED STUBOUT CONNECTIONS, RAIN GARDENS, BIORETENTION SYSTEMS, PERMEABLE PAVEMENT, SHEETFLOW DISPERSION, AND CONCENTRATED FLOW DISPERSION. THE AREAS ON THE SITE TO BE USED FOR THESE BMP'S SHALL BE PROTECTED FROM SILTATION AND COMPACTION DURING CONSTRUCTION BY SEQUENCING THE CONSTRUCTION IN A FASHION TO INSTALL THESE BMP'S AT THE LATTER PART OF THE CONSTRUCTION GRADING OPERATIONS, BY EXCLUDING EQUIPMENT FROM THE BMP'S AND THE ASSOCIATED AREAS, AND BY USING THE EROSION AND SEDIMENTATION CONTROL BMP'S.

No.	Description	Date

Wise Choice Construction

Retaining Wall

7905 W Mercer Way, Mercer Island, WA 98040

Project number	A23-1206
Date	09.26.2025
Drawn by	Alexander Litvinov
Checked by	-

CSWPPP and TESC PLAN

A-1.1  
Scale 1" = 20'-0"

© National Design Corporation  
This drawing along with referenced drawings and specifications are and shall remain the property of National Design. These are specifically developed for the project shown on this drawing and shall not be used for extensions of this project or any others projects without a written agreement with or approval.

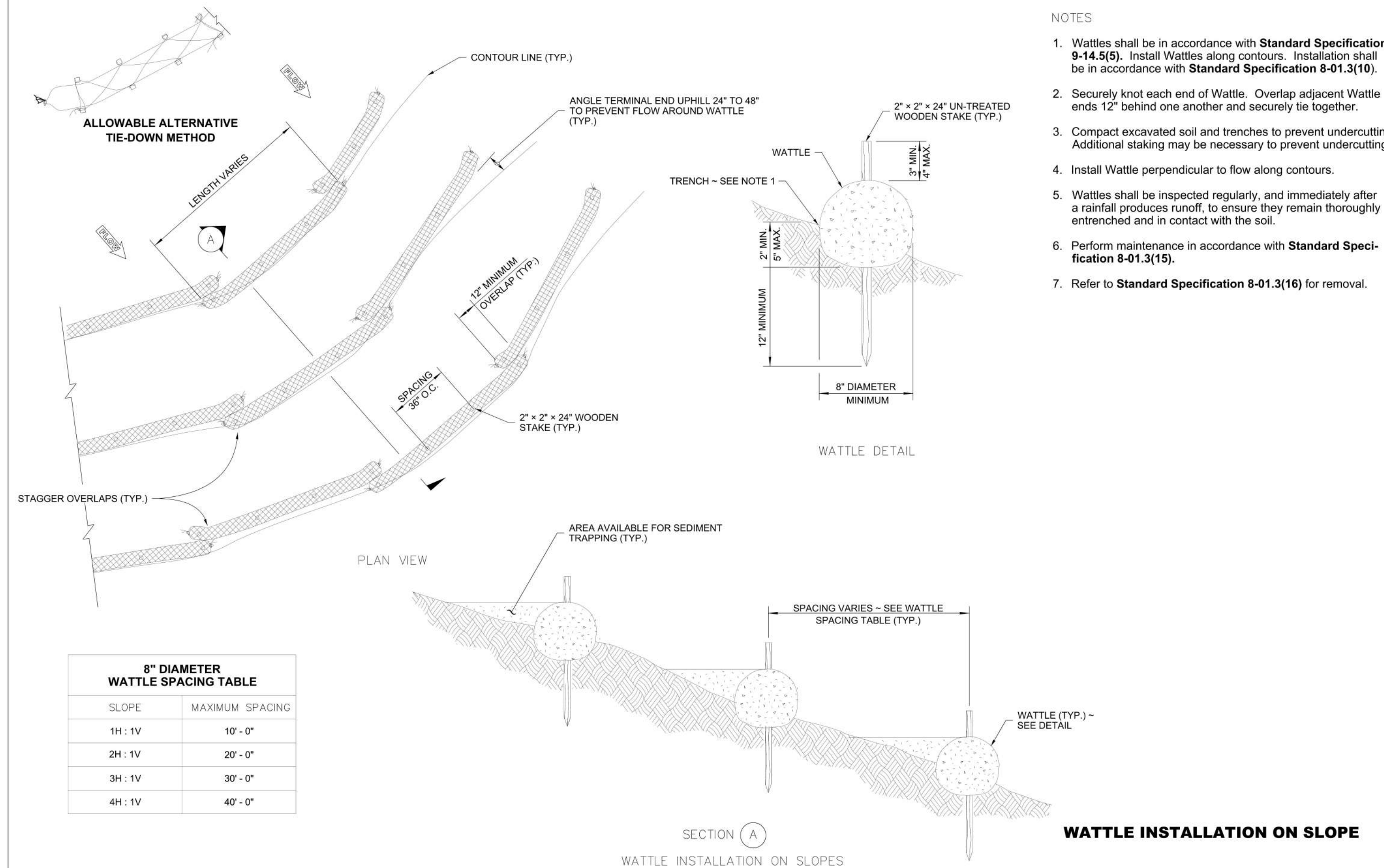

- NOTES
1. Wattles shall be in accordance with **Standard Specification 9-14.5(5)**. Install Wattles along contours. Installation shall be in accordance with **Standard Specification 8-01.3(10)**.
  2. Securely knot each end of Wattle. Overlap adjacent Wattle ends 12" behind one another and securely tie together.
  3. Compact excavated soil and trenches to prevent undercutting. Additional staking may be necessary to prevent undercutting.
  4. Install Wattle perpendicular to flow along contours.
  5. Wattles shall be inspected regularly, and immediately after a rainfall produces runoff, to ensure they remain thoroughly entrenched and in contact with the soil.
  6. Perform maintenance in accordance with **Standard Specification 8-01.3(15)**.
  7. Refer to **Standard Specification 8-01.3(16)** for removal.

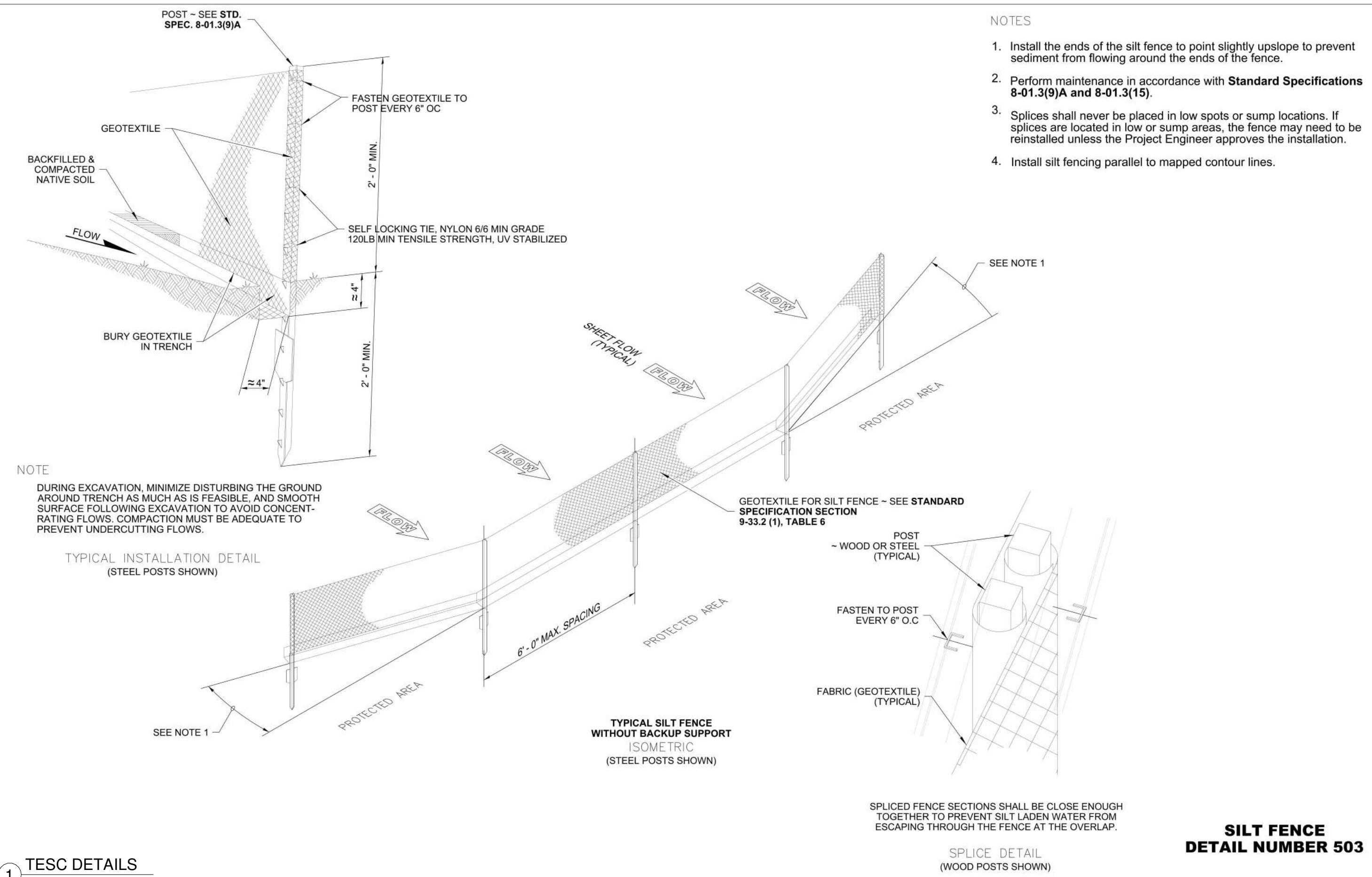

**SILT FENCE DETAIL NUMBER 503**

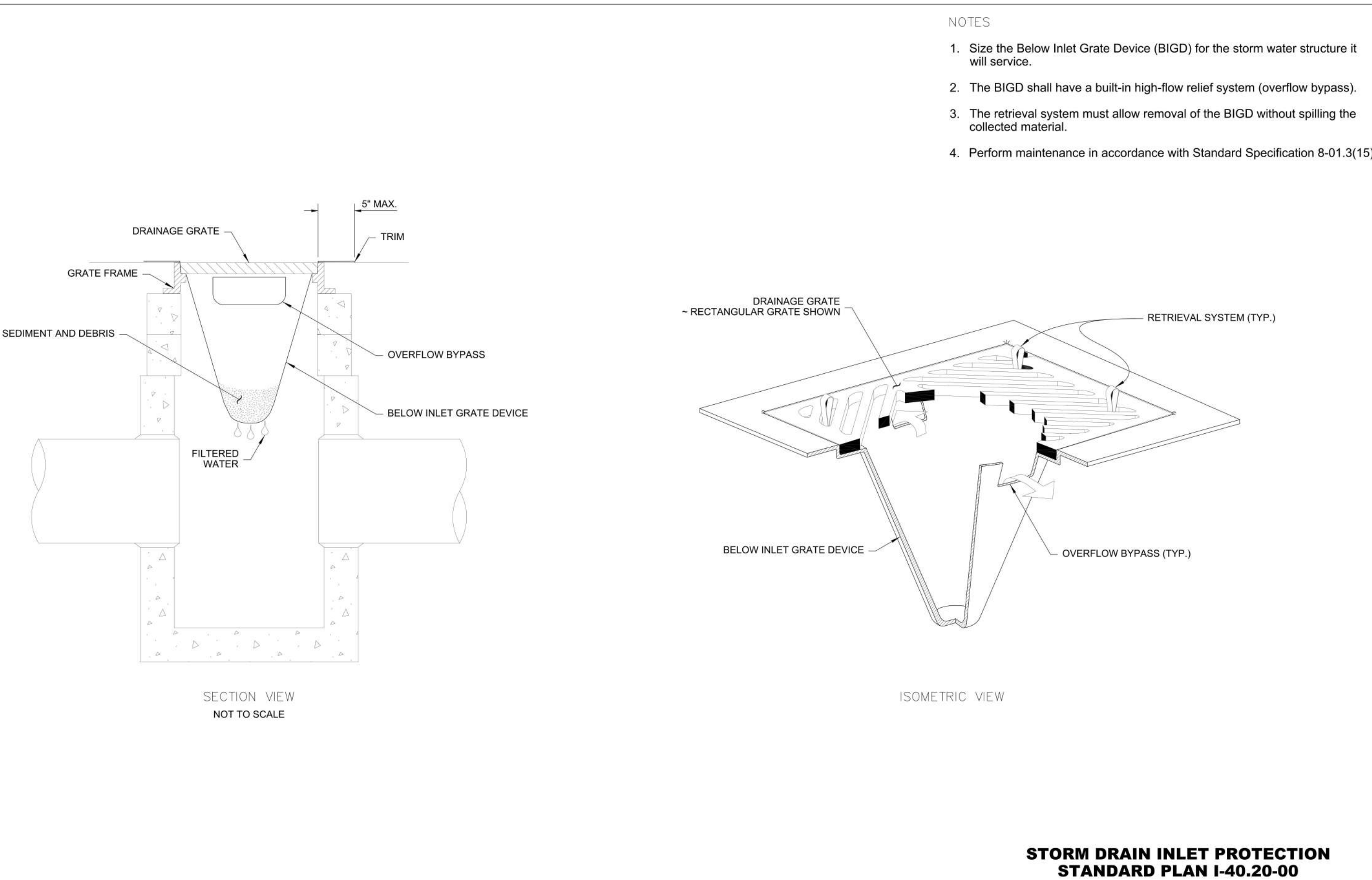

**STORM DRAIN INLET PROTECTION STANDARD PLAN I-40.20-00**

1 TESC DETAILS  
IS DIAGRAM JUST FOR SHOW

No.	Description	Date

Wise Choice Construction  
Retaining Wall  
7905 W Mercer Way, Mercer Island, WA 98040

Project number	A23-1206
Date	09.26.2025
Drawn by	Alexander Litvinov
Checked by	-

TESC DETAILS

A-1.2